

MUTINA

# Brac

by Nathalie Du Pasquier

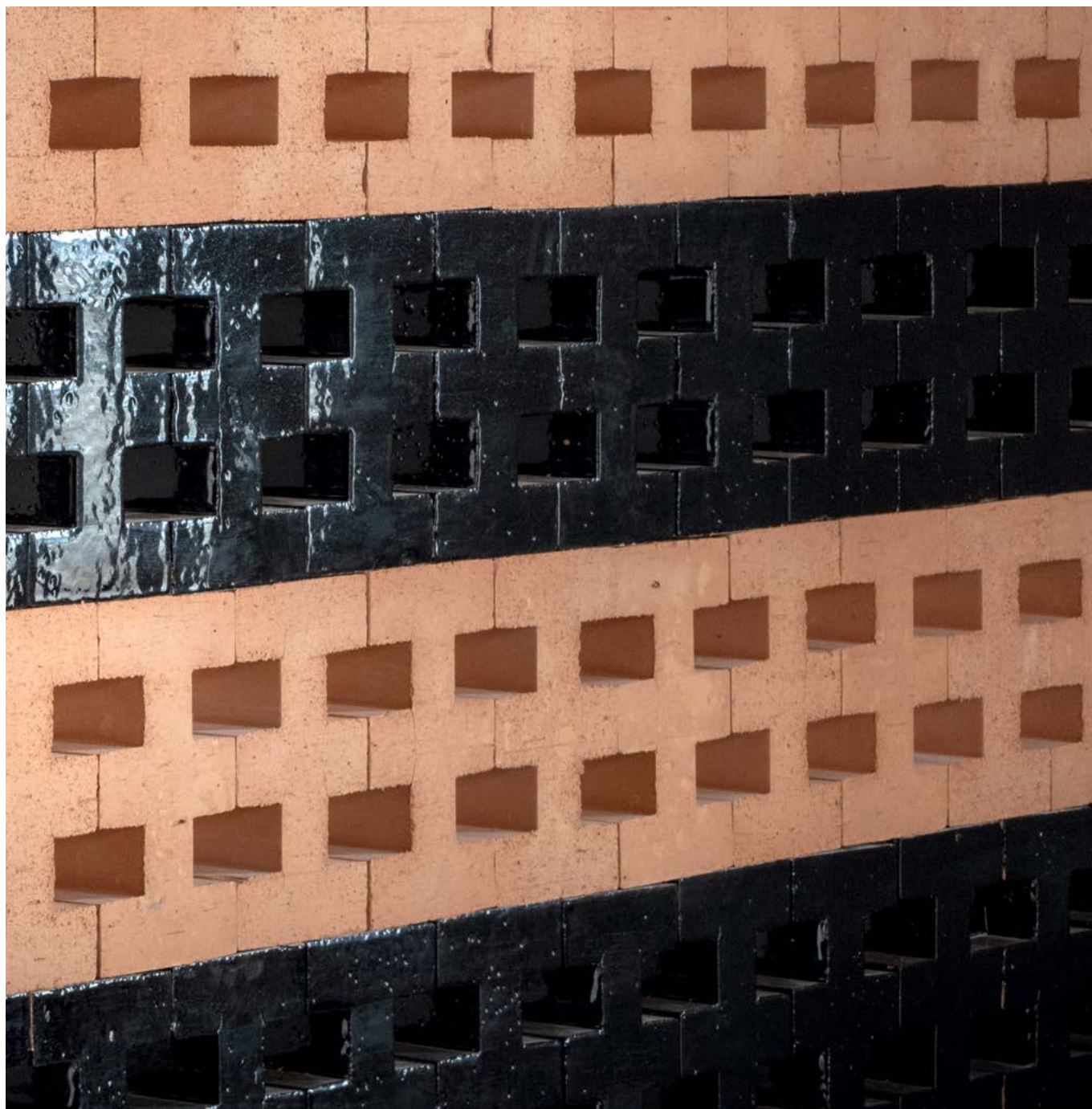

EN

General information  
Laying and maintenance tips  
Colors  
Technical features  
Packing

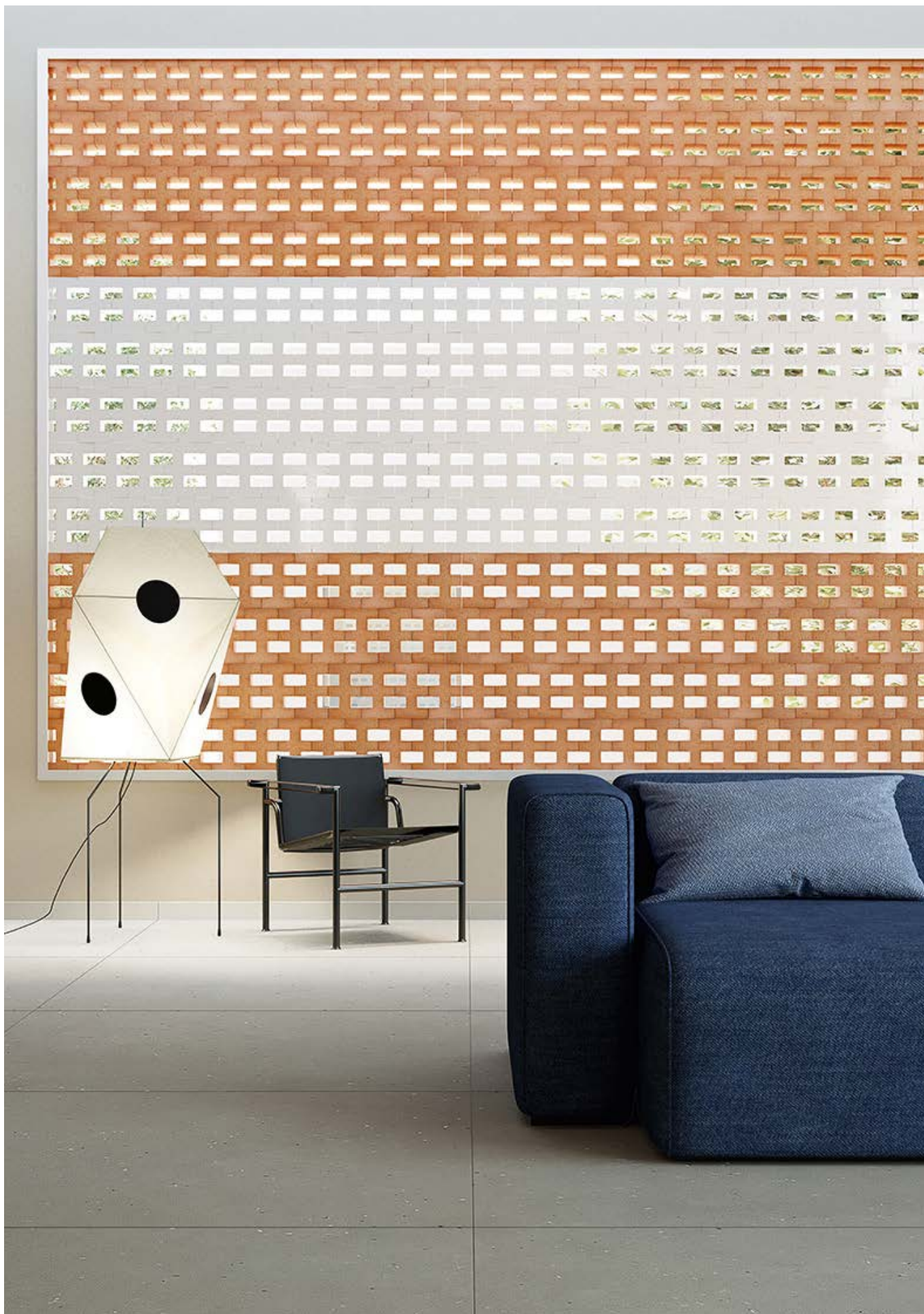

# General information

The data, information and indications contained in this technical data sheet and in further documents relating to the Brac by Nathalie Du Pasquier product are the exclusive property by Ceramiche MUTINA S.p.a. This Technical Data Sheet provides the buyer with information relating to the use of the product useful for its correct installation and evaluation and prevention of risks arising from the normal use of the same.

collection	Brac
design	Nathalie Du Pasquier, 2019
production	Artisanal
material	Extruded terracotta
thickness	10 cm
nominal sizes	12,5x22x10 cm
specification	<ul style="list-style-type: none"> <li>- artisanal extruded partition elements, 10cm thick.</li> <li>- 5 colours: Argilla (natural finishing), Bianco, Salvia, Marrone, Nero (glossy painted finishing)</li> <li>- 3 different laying patterns are possible (see attached document).</li> </ul> <p>This product is suitable for both residential and commercial areas, to be installed in walls with height of 4mt. These elements must in any case comply with the technical standards of construction regulation, applicable in the country where they are installed. For the Italian national territory, in particular, they should comply with standard NTC 2018 DECRETO MIN 27/01.</p> <p>In order to achieve an optimal aesthetic outcome we advise to install BRAC using our wooden profile. The profile is painted and suitable for outdoor use. A top profile with removable sides is provided for ceiling fixing. As complementary pieces Mutina provide the Mutina adhesive, EC 1 plus for VOC emissions. For installation process see the installation video available on <a href="http://www.mutina.it">www.mutina.it</a>.</p> <p>Brac Argilla is suitable for indoor and outdoor areas complying with UNI EN 772-22 marked "F1- moderate exposure". Brac Bianco, Nero, Salvia and Marrone are suitable for indoor only.</p>
awards	Interior Design Magazine's Best of Year Awards 2020 in the Category Architectural Products
patents	Registered design n° 007510870-0041/0044 - date of registration: 14/01/2020
category	UNI 11128/2004

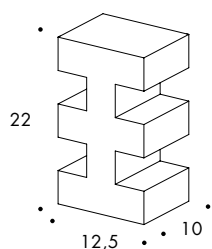

## complementary pieces

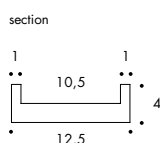
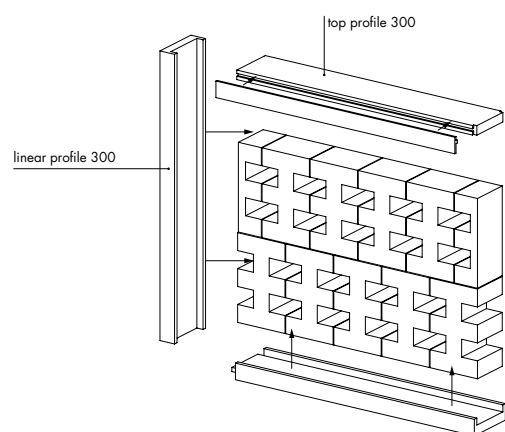

### colours



To make the installation of these items easier, a Mutina adhesive is now available: organic, eco-friendly and sold separately.

laying scheme

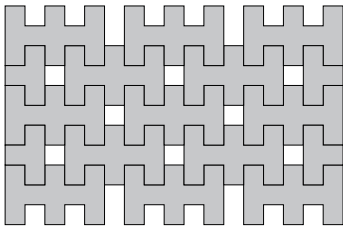

laying scheme 1  
43,20 pcs / sqm

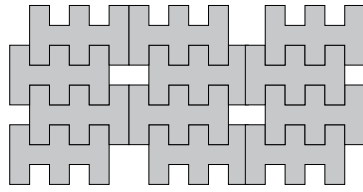

laying scheme 2  
43,20 pcs / sqm

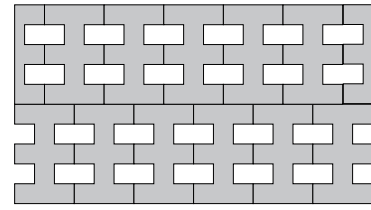

laying scheme 3  
36 pcs / sqm

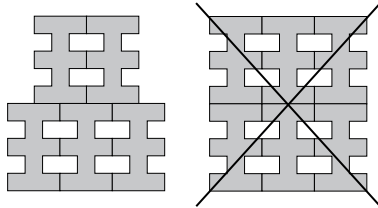

For security reasons only staggered installation is strictly allowed.

**ANCHORING ON 2 SIDES**  
Max h 400 cm

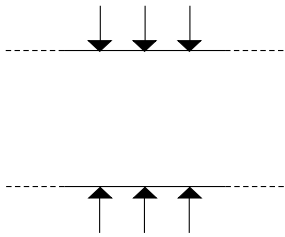

**ANCHORING ON 3 SIDES**  
Max h 400x300 cm

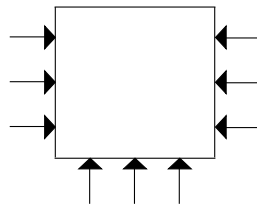

**ANCHORING ON 2 SIDES**  
MAX h250x100 cm

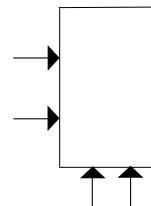

## Laying and maintenance tips

use	Wall – indoor Wall – outdoor in moderate exposure areas for Brac Argilla only
installation	For security reasons only staggered installation is strictly allowed.
recommended adhesive	Mutina adhesive: solvents-free, eco-friendly organic adhesive.
recommended joints	–
recommended fillers	–
cleaning at the end of installation	Avoid drippings during installation. If needed the excess can be removed after the product has dried, using a tool with a sharp edge.
general cleaning (installed tiles)	–
calibers (real size)	12,5 x 22 x 10 cm with 3 mm tolerance (artisanal product)

## Colours



Argilla



Bianco



Nero



Salvia



Marrone

## Technical features

STANDARD	FEATURES	VALUE REQUIRED	BRAC
UNI EN 772-16	dimensions	to declare	T2-R2
UNI EN 772-21	water absorption	to declare	12,5%
UNI EN 772-5	soluble salts content	to declare	S2
UNI EN 772-22	freeze-thaw resistance	to declare	F1
D.M. 1401/2008	determination of variable horizontal loads	to declare	C2
Leed 4.1			10%
VOC Emission			available upon request
Declaration of Contents			available upon request
SDS			available upon request
BPD3			available upon request
HPD			available upon request

## Packing

SIZE	PCS-SQM	PCS-BOX	SQM-PAL	PCS-PAL	KG-PC	KG-PAL
22·12,5·10 cm argilla		–	1,30	48	3,70	177,60
22·12,5·10 cm bianco,nero,salvia,marrone		3	3,91	144	3,70	532,80
Scheme 1	43,20					
Scheme 2	43,20					
Scheme 3	36					